



WELCOME!

We are happy to be hosting the April 14 Metro Speech and Debate tournament at [Maret School!](#) In this document, I have included directions for getting here, a schedule for the day and campus maps. We will have several student volunteers around to help with directions and to run ballots. If you have any questions, please feel free to ask me or one of the volunteers! We are looking forward to a wonderful day of debate!

John Jai

SCHEDULE

8:30 AM - Arrival, Breakfast, Registration and Payment

Explanation of Rounds and Process for the day

9:30 AM - Round 1 PF

10:45 AM - Round 2 PF

11:45 AM - Round 3 PF

12:45 PM - Lunch

1:30 PM - Round 4 PF

2:45 PM - Final Round PF (top 2 teams)

4:15 PM - Awards

GETTING HERE ([3000 Cathedral Ave. NW, Washington, DC](#))

We are accessible by Metro on the Red Line (Woodley Park stop). From the Metro, it is about a 15 minute walk to campus.

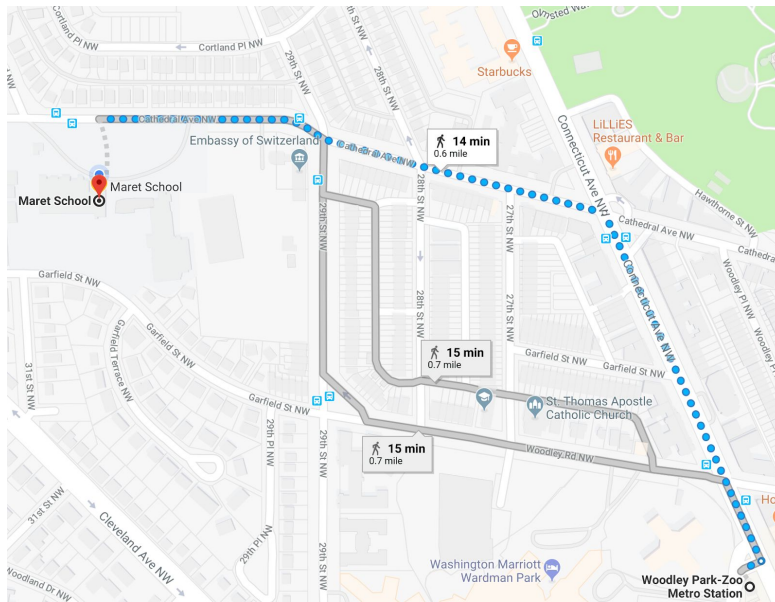

If you drive, you can park on-campus in either the upper or lower lots.

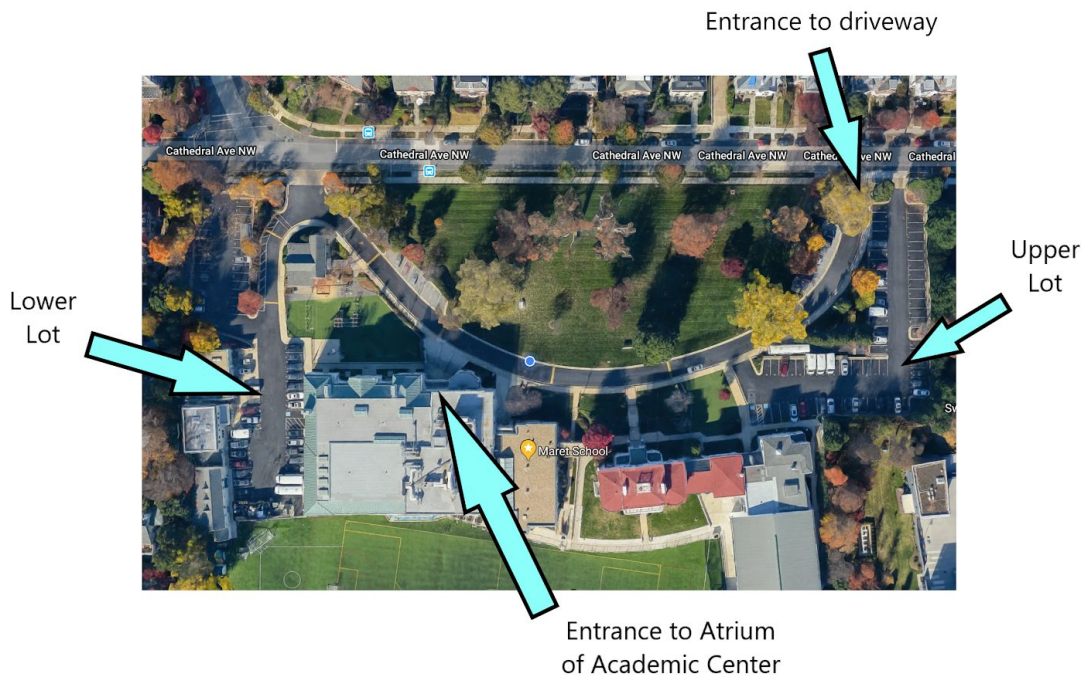

All rounds will be held in the Academic Center. The Academic Center is the building to the right of the large white building with the columns (Woodley Building) as you face it. Enter the Academic Center through the Atrium, which is directly off the driveway.

ROOMS

Rounds will be held in classrooms on the 2nd, 3rd and 4th floors.

Please be respectful of the rooms and return all desks, chairs and other items to where they were when you entered the room. Thanks!

Tab will be in the Faculty Lounge on the 3rd floor.

Students can stay in the Atrium on the 2nd floor or the cafeteria on the 1st floor.

Lunch will be in the cafeteria on the 1st floor.

The Judges' Lounge will be in the Humanities Conference Room on the 4th floor.

Judges can also stay in the Atrium on the 2nd floor.

MAPS

Academic Center & Talbott Hall: SECOND FLOOR

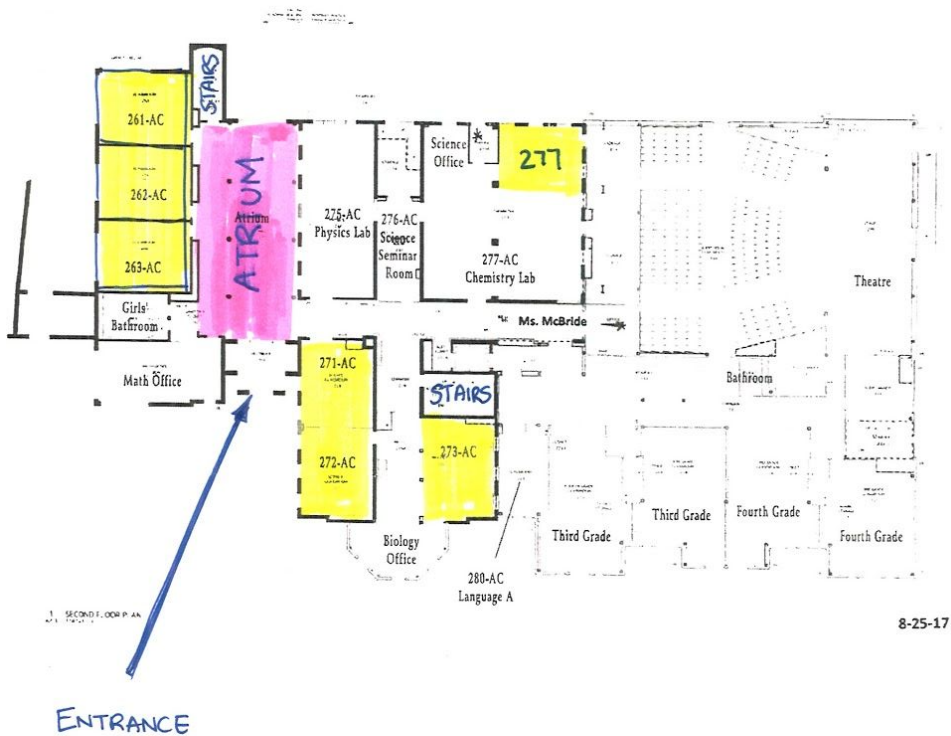

Academic Center & Talbott Hall: THIRD FLOOR



Academic Center: FOURTH FLOOR

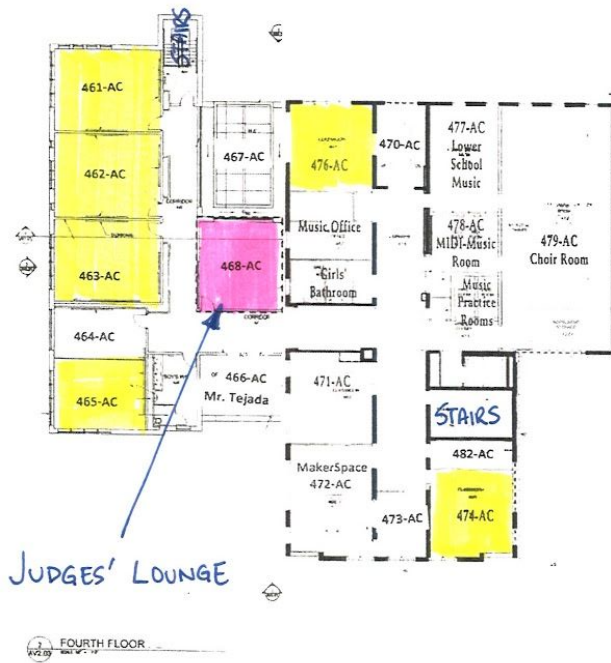

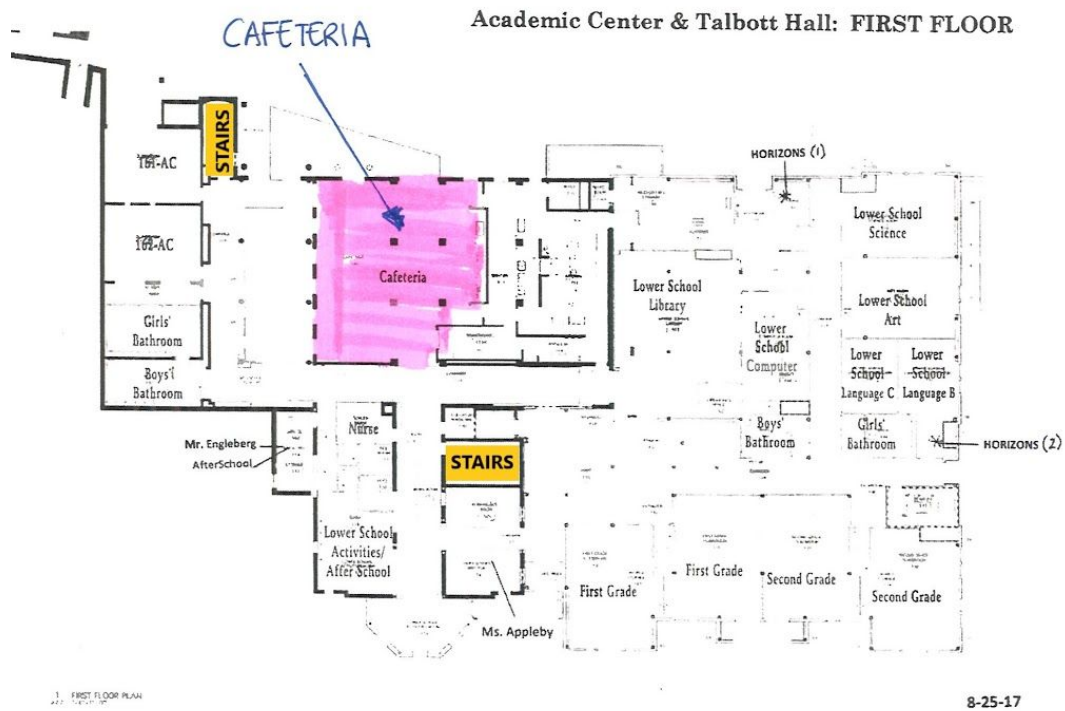

CONTACTS

We hope you have a great tournament! Please let us know if you have any questions or need help!

John Jai (jjai@maret.org)

Lynn Levinson (llevinson@maret.org)